

7

Drawer Runners





“Our Design Studios are equipped with an extensive range of displays attuned to their local market, so can see and experience the quality first hand”.





Roller Guided



Single extension, load bearing capacity up to 25 kg 7.6

Single extension, load bearing capacity up to 30 kg 7.6

Ball Guided



Single extension, load bearing capacity up to 10 kg 7.7

Single extension, load bearing capacity up to 25 kg 7.7

Single extension, load bearing capacity up to 60 kg 7.8

Full extension, load bearing capacity up to 30 kg 7.9

Full extension, load bearing capacity up to 50 kg 7.11

Conceal Dynamic Runners



Single extension, load bearing capacity up to 30 kg 7.12

Full extension, load bearing capacity up to 30 kg 7.13

GRASS Full extension, load bearing capacity up to 40 kg7.14

Accessories



GRASS NOVA PRO Railing system 7.16

Drillig jig for GRASS Interwood 7.18

Spacer bar for drawer runners 7.19

Kitchen worlds. Moved by Grass.



Grass moves through differentiating design.

Recognized with many awards and employed by the world's best designers - that's furniture hardware by Grass. Both hinge and slide systems offer impressive product design and function, which in turn enable unique furniture design. For the world's best and most attractive kitchens.

Kitchens of the world. Moved by Grass.





Häfele Functionality: The highest standards in design and function

Häfele offers you a versatile drawer runner range, allowing you to configure drawers according to the individual needs. This standard of quality you have come to expect from Häfele, can once again be found within our new and innovative extensive range of drawer runner applications and requirements.

Visit us in our Häfele Design Studios and consider our complete range of drawer runner by means of furniture mock-ups. If you have a project for which you are considering using our fittings then our experienced sales team are ready to assist you in selecting products and creating the specification.



Roller guided
Single extension, load bearing capacity
up to 25 kg
(Page 7.6)



Roller guided
Single extension, load bearing capacity
up to 30 kg
(Page 7.6)



Ball guided
Single extension, load bearing capacity
up to 10 kg
(Page 7.7)



Ball guided
Single extension, load bearing capacity
up to 60 kg
(Page 7.8)





GRASS NOVA PRO Railing systems
(Page 7.16)



Conceal dynamic runner
GRASS Interwood
full extension runner include snap-in device
(Page 7.15)



Conceal dynamic runner
GRASS Interwood,
full extension runner
(Page 7.15)



Conceal dynamic runner
Single extension, load bearing capacity
up to 30 kg
(Page 7.12)

Single extension, load bearing capacity up to 25 kg



- Material: Steel
- Guided by: 4 friction bearing mounted nylon rollers
- Thickness: 1.2 mm
- Type of closing: Self closing
- Fitting to side panel: Screw fixing
- Fitting to drawer: Screw fixing surface mounted



Nominal length L	Cream, RAL 9001
300 mm	423.36.318
350mm	423.36.363
400 mm	423.36.416
450 mm	423.36.461
500 mm	423.36.514
550 mm	423.36.569
600 mm	423.36.612

Packing: 1 pair

Single extension, load bearing capacity up to 30 kg



- Material: Steel
- Guided by: 4 friction bearing mounted nylon rollers
- Thickness: 1.2 mm
- Type of closing: Self closing
- Fitting to side panel: Screw fixing
- Fitting to drawer: Screw fixing surface mounted

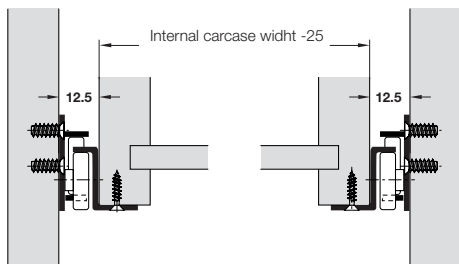

Installation

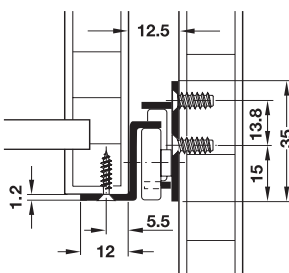

Nominal length L	Black RAL 9011	Brown, RAL 8017	White aluminium similar RAL 9006	White RAL 9010
250 mm	423.08.326	423.08.126	423.08.226	423.08.726
300 mm	423.08.331	423.08.131	423.08.231	423.08.731
350mm	423.08.336	423.08.136	423.08.236	423.08.736
400 mm	423.08.341	423.08.141	423.08.241	423.08.741
450 mm	423.08.346	423.08.146	423.08.246	423.08.746
500 mm	423.08.351	423.08.151	423.08.251	423.08.751
550 mm	423.08.356	423.08.156	423.08.256	423.08.756
600 mm	423.08.361	423.08.161	423.08.261	423.08.761

Packing: 1,10 or 20 pairs

Single extension, load bearing capacity up to 10 kg



- Material: Steel
- Finish: Galvanized
- Guided by: 2 Ball cages
- Thickness: 1.0 mm
- Fitting to side panel: Screw fixing
- Fitting to drawer: Screw fixing, fitting in grooves

Drawer rail SL	Carcase rail L	Extension loss AV	Cat. No.
185 – 290 mm	182 mm	74 mm	420.59.918
250 – 420 mm	246 mm	71 mm	420.59.925
315 – 550 mm	310 mm	74 mm	420.59.931

Packing: 1 or 50 pairs

Single extension, load bearing capacity up to 25 kg

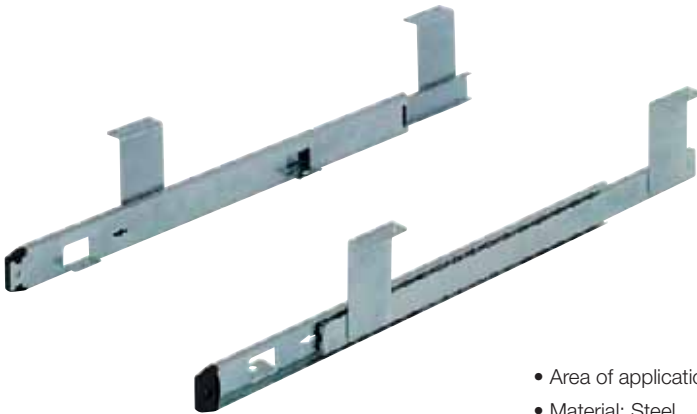

- Area of application: For shelves and keyboards
- Material: Steel
- Finish: Galvanized
- Version: With stay closed feature for holding in closed position
- Fitting to table top: Screw fixing beneath table top
- Fitting to shelf: Screw fixing beneath shelf
- Mounting bracket: Fixed

Installation

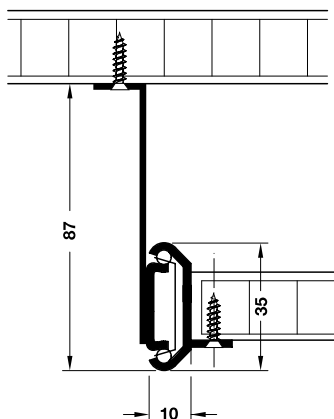

Installation length L	Extension length AL	Extension loss AV	Cat. No.
410 mm	295 mm	115 mm	420.34.941

Packing: 1 or 10 pairs

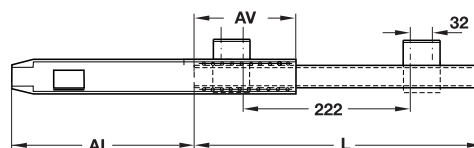

We reserve the right to alter specifications without notice (SEA Basic 2008/09).

Single extension, load bearing capacity up to 60 kg

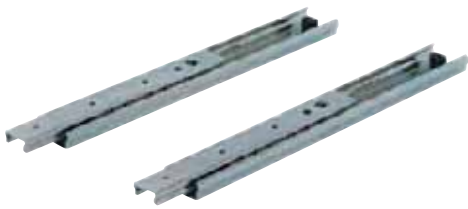

- Area of application: For keyboards and drawers
- Material: Steel
- Finish: Galvanized
- Guided by: 2 Ball cages
- Drawer width: Max. internal carcass width -43 mm
- Installation: Screw fixing to shelf or drawer, surface or side mounted

Carcass rail L	Extension length AL	Extension loss AV	Cat. No.
350 mm	230 mm	120 mm	422.60.337

Packing: 1 pair

Installation

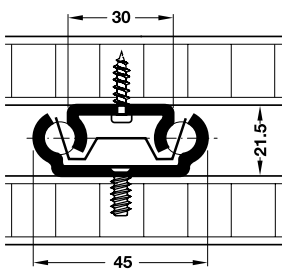

Mounted as shelf runner

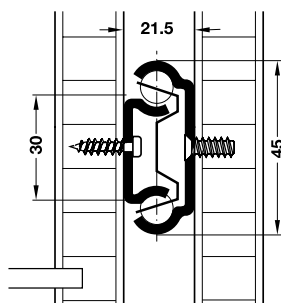

Mounted as drawer runner

Drilling dimensions

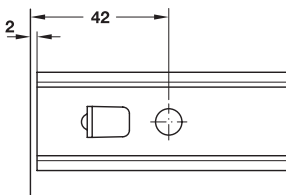

Full extension, load bearing capacity up to 30 kg



Installation

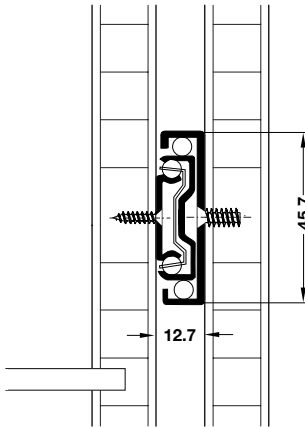

- Material: Steel
- Finish: Galvanized or black galvanized
- Guided by: 2 Ball cages
- Version: Can be disengaged using release lever, with stay closed feature for holding in closed position
- Temperature range: -20 to +80 °C
- Fitting to side panel: Screwing into 32 mm series drilled holes
- Fitting to drawer: Screw fixing, lateral installation

Installation length L	Extension length AL	Galvanized	Black galvanized
250 mm	250 mm	422.25.258	422.25.267
300 mm	300 mm	422.25.301	422.25.310
350mm	350mm	422.25.356	422.25.365
400 mm	400 mm	422.25.409	422.25.418
450 mm	450 mm	422.25.454	422.25.463
500 mm	500 mm	422.25.507	422.25.516
550 mm	550 mm	422.25.552	422.25.561
600 mm	600 mm	422.25.605	422.25.614
650 mm	650 mm	422.25.650	422.25.669
700 mm	700 mm	422.25.703	422.25.712

Packing: 1 pair

Disengaging

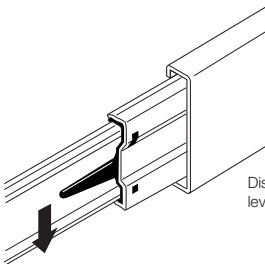

Disengage by operating the release lever in the drawer rail.

Drilling dimension

Front edge of carcass

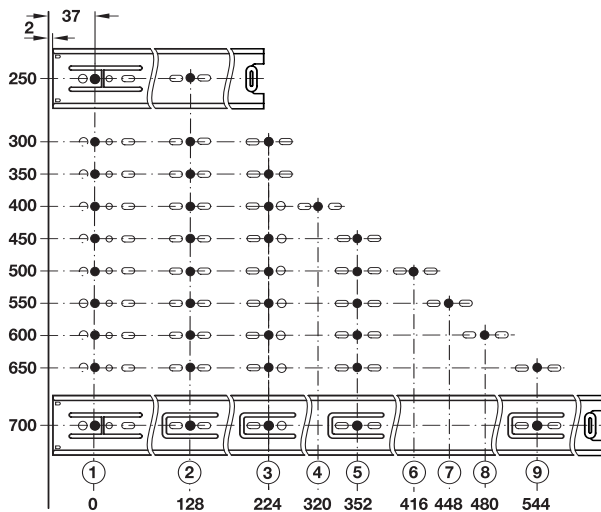

Load bearing capacity

Load bearing capacity refer to rail length 450 mm and extension width 450 mm.

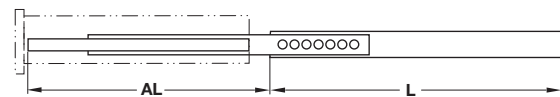

We reserve the right to alter specifications without notice (SEA Basic 2008/09).

Full extension, load bearing capacity up to 30 kg



Installation

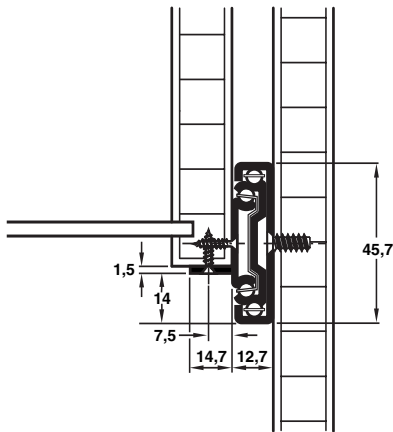

- Material: Steel
- Finish: Galvanized or black galvanized
- Guided by: 2 Ball cages
- Version: Can be disengaged using release lever, with stay closed feature for holding in closed position
- Temperature range: -20 to +80 °C
- Fitting to side panel: Screwing into 32 mm series drilled holes
- Fitting to drawer: Screw fixing, surface mounted installation

Installation length L	Extension length AL	Galvanized	Black galvanized
250 mm	250 mm	422.30.925	422.30.325
300 mm	300 mm	422.30.930	422.30.330
350mm	350mm	422.30.935	422.30.335
400 mm	400 mm	422.30.940	422.30.340
450 mm	450 mm	422.30.945	422.30.345
500 mm	500 mm	422.30.950	422.30.350
550 mm	550 mm	422.30.955	422.30.355
600 mm	600 mm	422.30.960	422.30.360
650 mm	650 mm	422.30.965	422.30.365
700 mm	700 mm	422.30.970	422.30.370

Packing: 1 pair

Disengaging

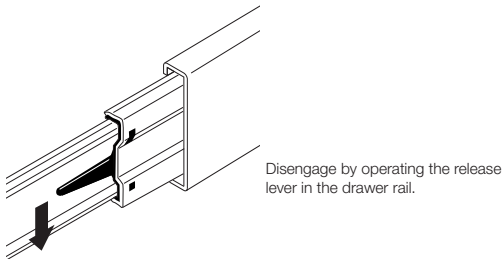

Drilling dimension

Front edge of carcase

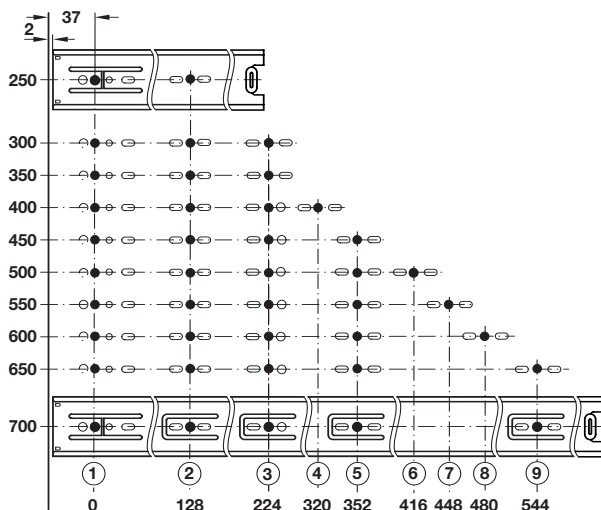

Load bearing capacity

Load bearing capacity refer to rail length 450 mm and extension width 450 mm.

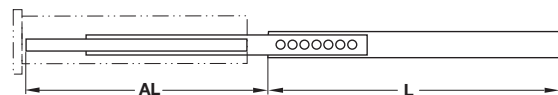

Note

Retainer retention with soft stop when closing by special rubber buffer.

Full extension, load bearing capacity up to 50 kg

► *New Arrival!*
German Technology

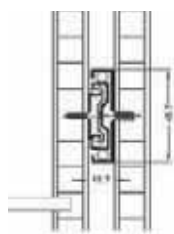

Side mounted

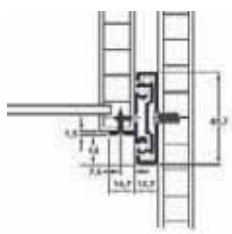

Bottom mounted

- Material: Steel
- Material thickness: 1.5 mm
- Guided by: 2 Ball cages
- Type of closing: Soft closing
- Temperature range: -5 to +30 °C
- Fitting to side panel: Screwing in 32 mm series drilled holes
- Fitting to drawer: Screw fixing, lateral installation

Side mounted

Extension length AL	Extension loss AV	Load bearing capacity	Galvanized
300 mm	150 mm	25.0 kg	432.16.930
350 mm	280 mm	25.0 kg	432.16.935
400 mm	380 mm	25.0 kg	432.16.940
450 mm	430 mm	37.5 kg	432.16.945
500 mm	480 mm	37.5 kg	432.16.950
550 mm	530 mm	50.0 kg	432.16.955
600 mm	580 mm	50.0 kg	432.16.960
650 mm	630 mm	37.5 kg	432.16.965
700 mm	680 mm	37.5 kg	432.16.970

Packing: 1 pair

Bottom mounted

Extension length AL	Extension loss AV	Load bearing capacity	Galvanized
300 mm	150 mm	25.0 kg	432.18.930
350mm	280 mm	25.0 kg	432.18.935
400 mm	380 mm	25.0 kg	432.18.940
450 mm	430 mm	37.5 kg	432.18.945
500 mm	480 mm	37.5 kg	432.18.950
550 mm	530 mm	50.0 kg	432.18.955
600 mm	580 mm	50.0 kg	432.18.960
650 mm	630 mm	37.5 kg	432.18.965
700 mm	680 mm	37.5 kg	432.18.970

Packing: 1 pair