

ADVU Series Interchangeable Compact Cylinders

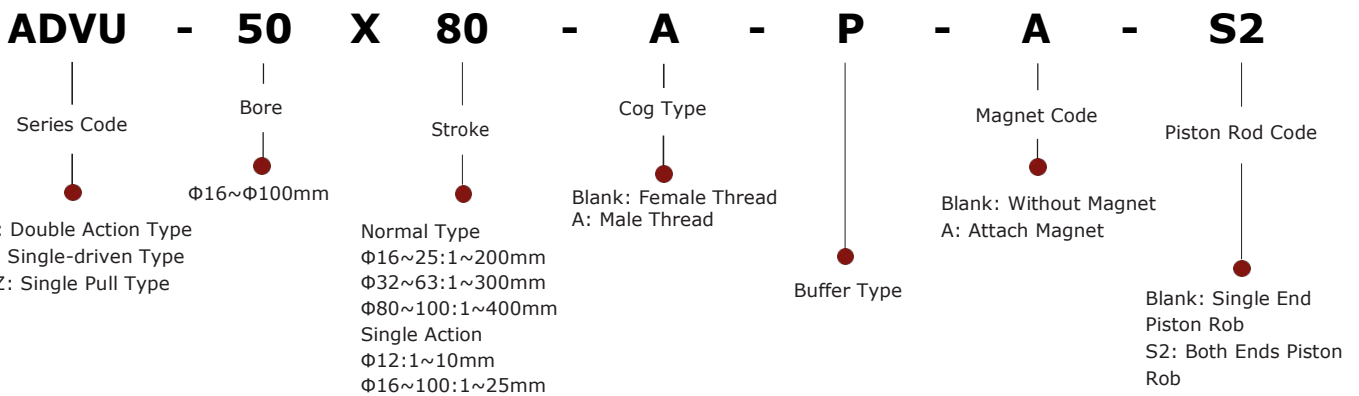

Ordering code



Specification

Bore (mm)		16	20	25	32	40	50	63	80	100	
Action		Double Action / Single Rod / Double Rod									
Fluid		Air									
Ensured Pressure Resistance		1.5 Mpa									
Operating Pressure Range	ADVU - - P-A	0.12~1.0 MPa	0.1~1.0 MPa	0.08~1.0 MPa			0.06~1.0 MPa				
	ADVU - - P-A-S2	0.13~1.0 MPa	0.12~1.0 MPa	0.1~1.0 MPa			0.8~1.0 MPa				
Ambient and Fluid Temperature		-20~80 °C (No freezing)									
Port Size		M5			G1/8"			G1/4"			
Piston Rod Thread	Female Thread	M4	M5	M6	M8	M10	M12				
	Male Thread	M8	M10×1.25			M12×1.25	M16×1.5	M20×1.5			
Cushion		Rubber Bumper									

Overall Dimensions

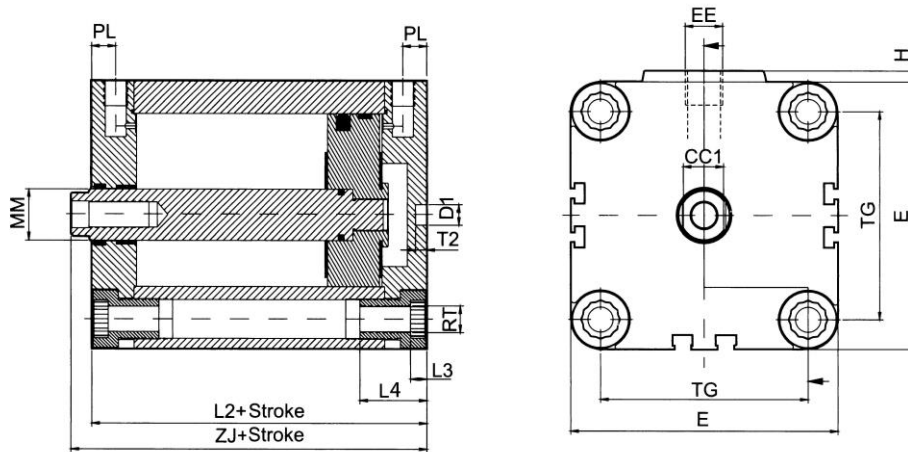

Note:
 To attach cylinder. 12 and 16 mm from above, use only 2 screws diagonally or non-magnetic screws.
 += plus stroke length
 2 Minimum screw-in depth

Dimension Sheet

Bore	D1	E	EE	H	L2	L3	L4	MM	PL	RT	T2	TG	ZJ	CC1
16	6	29	M5	1	38	4	185	8	8	M4	4	18	41	6
20	6	355	M5	15	38	4	185	10	8	M5	4	22	41	8
25	6	395	M5	15	395	4	185	10	8	M5	4	26	435	8
32	6	495	G1/8	2	445	5	22	12	8	M6	4	32	495	10
40	6	595	G1/8	25	455	5	22	12	8	M6	4	42	51	10
50	6	68	G1/8	28	465	5	22	16	8	M8	4	50	53	14
63	8	86	G1/8	4	50	6	26	16	8	M10	4	62	56	14
80	8	106	G1/8	4	56	6	26	20	85	M10	4	82	62	17
100	8	128	G1/4	5	665	8	26	35	105	M10	4	103	765	22